

FOURTH AVE

WASHINGTON ST

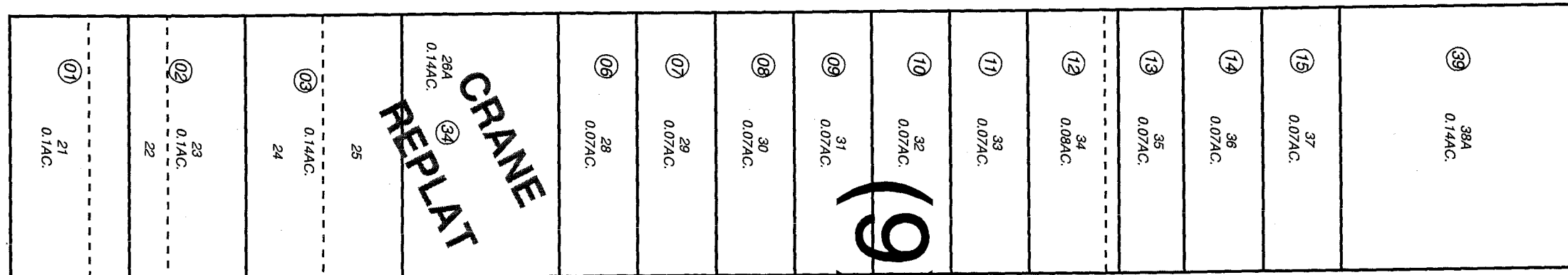

ADAMS ST

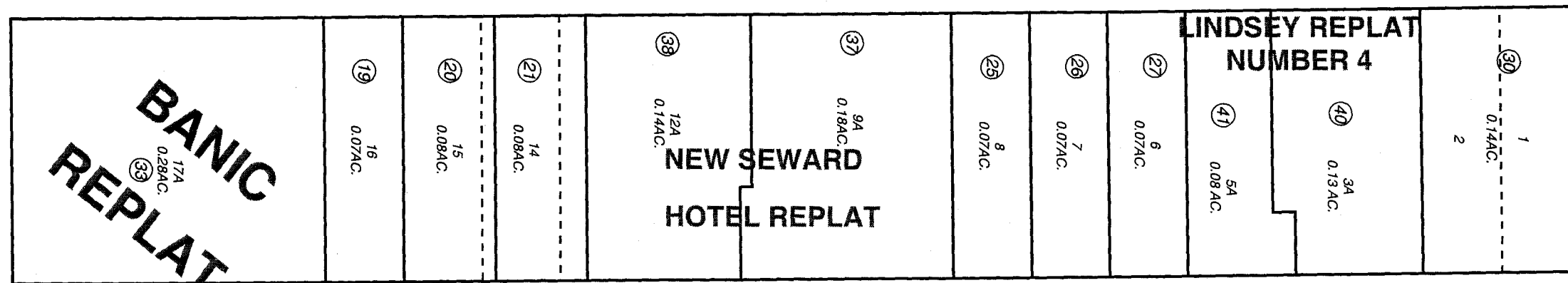

FIFTH AVE

FEBRUARY 1, 2006

For 2006 assessment roll		
Delete	Add	Revise
	To	
29,35,36	40,41	

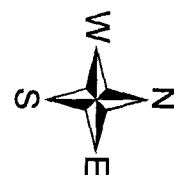

Assessor's Map
Kenai Peninsula Borough

ORIGINAL TOWNSITE OF SEWARD SW0000001
 SEWARD ORIGINAL TOWNSITE BANIC REPLAT SW0830008
 SEWARD TOWNSITE CRANE REPLAT SW0900010
 SEWARD TOWNSITE NEW SEWARD HOTEL REPLAT SW0940031
 SEWARD ORIGINAL TOWNSITE LINDSEY REPLAT NO 2 SW0980034
 SEWARD ORIGINAL TOWNSITE LINDSEY REPLAT NO 4 SW2005025

Note- Assessor's block Numbers Shown in Elipses
 Assessor's Parcel Numbers Shown in Circles

This map is prepared
 for Kenai Peninsula
 Borough Assessing Dept.
 use only and is not
 intended for conveyance
 nor is it a survey.