

POR. SEC. 13, T01S, R01W & SEC. 18, T01S, R01E, S.M.  
OF U.S.S. NO. 1651

145-340

ATS 1574

Resurrection Bay

SEC. 13  
SEC. 18

330

320

BK  
189

There are leaseholds on the following parcels, and are shaded gray on the map:

- 14534021LH01
- 14534022LH01
- 14534023LH01
- 14534024LH02
- 14534025LH02
- 14534029LH01
- 14534039LH01
- 14534039LH02
- 14534046LH01
- 14534056LH02
- 14534058LH01
- 14534061LH01
- 14534063LH01

SEWARD CITY LIMITS

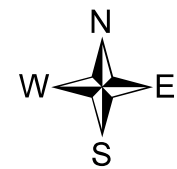
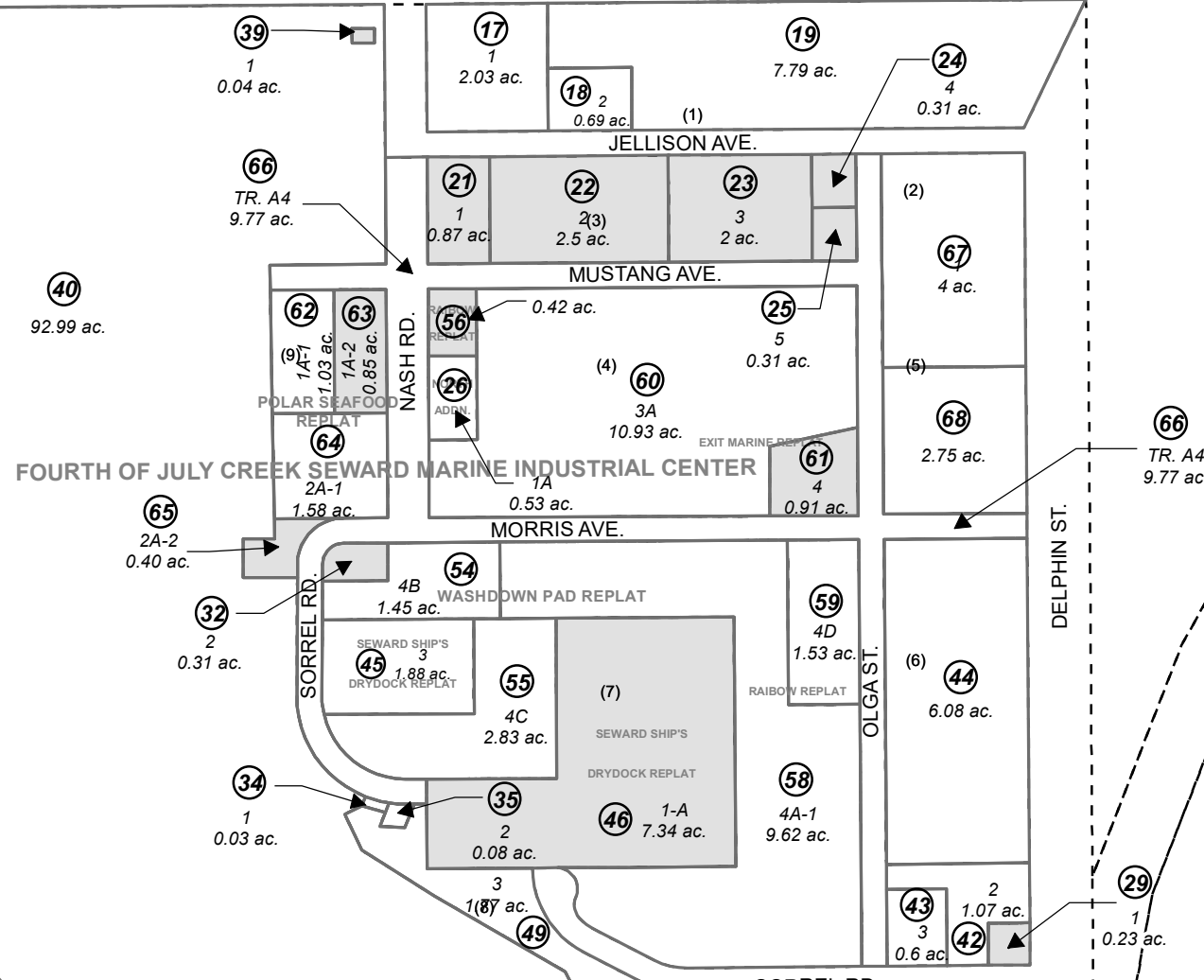

0 200 400 Feet

JUNE 16, 2022

For 2023 assessment roll		
Delete	Add	Revise
To		
20,28,41, 50,51	62-68	
51LH01	63LH01	

FOURTH OF JULY CREEK SUB SEWARD MARINE INDUSTRIAL CENTER SW0970027  
 FOURTH OF JULY CREEK SUB SEWARD MARINE INDUSTRIAL CENTER COMMUNICATIONS NORTH ADDN SW0000006  
 FOURTH OF JULY CREEK SUB SEWARD MARINE INDUSTRIAL CENTER ADDN NUMBER ONE SW2001002  
 FOURTH OF JULY CREEK SUB SEWARD MARINE INDUSTRIAL CENTER SEWARD SHIP'S DRYDOCK REPLAT SW2002022  
 FOURTH OF JULY CREEK SUB SEWARD MARINE INDUSTRIAL CENTER SEWARD POLAR SEAFOOD REPLAT SW2006023  
 FOURTH OF JULY CREEK SUB SEWARD MARINE INDUSTRIAL CENTER WASHDOWN PAD REPLAT SW2014017  
 FOURTH OF JULY CREEK SUB SEWARD MARINE INDUSTRIAL CENTER RAIHOW REPLAT SW2015014  
 FOURTH OF JULY CREEK SUB SEWARD MARINE INDUSTRIAL CENTER EXIT MARINE REPLAT SW2017013  
 FOURTH OF JULY CREEK SUB SEWARD MARINE INDUSTRIAL CENTER COASTAL LOTS REPLAT SW2022001  
 FOURTH OF JULY CREEK SUB SEWARD MARINE INDUSTRIAL CENTER FIRE DEPT REPLAT SW2022002

Assessor's Map  
Kenai Peninsula Borough

This map is prepared for Kenai Peninsula Borough Assessing Dept. use only and is not intended for conveyance nor is it a survey.

Note- Assessor's block Numbers Shown in Elipses  
Assessor's Parcel Numbers Shown in Circles